

LOCATION PLAN

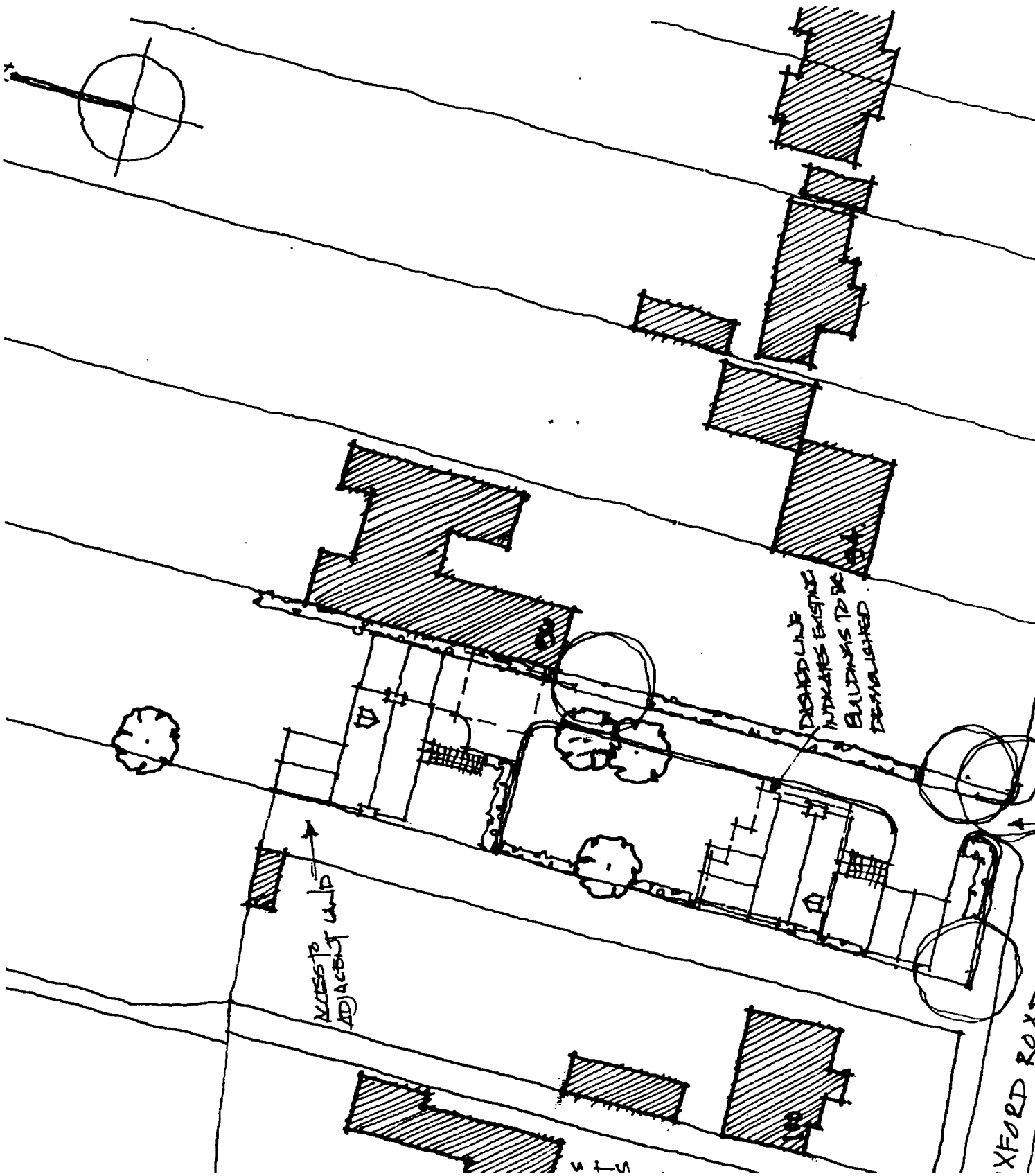
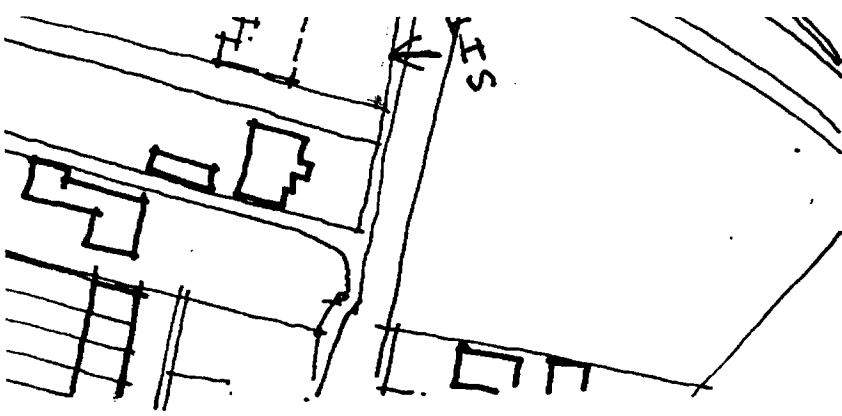

ACCESS TO ADJACENT LAND

DASHED LINE INDICATES EXISTING BUILDINGS TO BE DEMOLISHED

XFORD ROAD

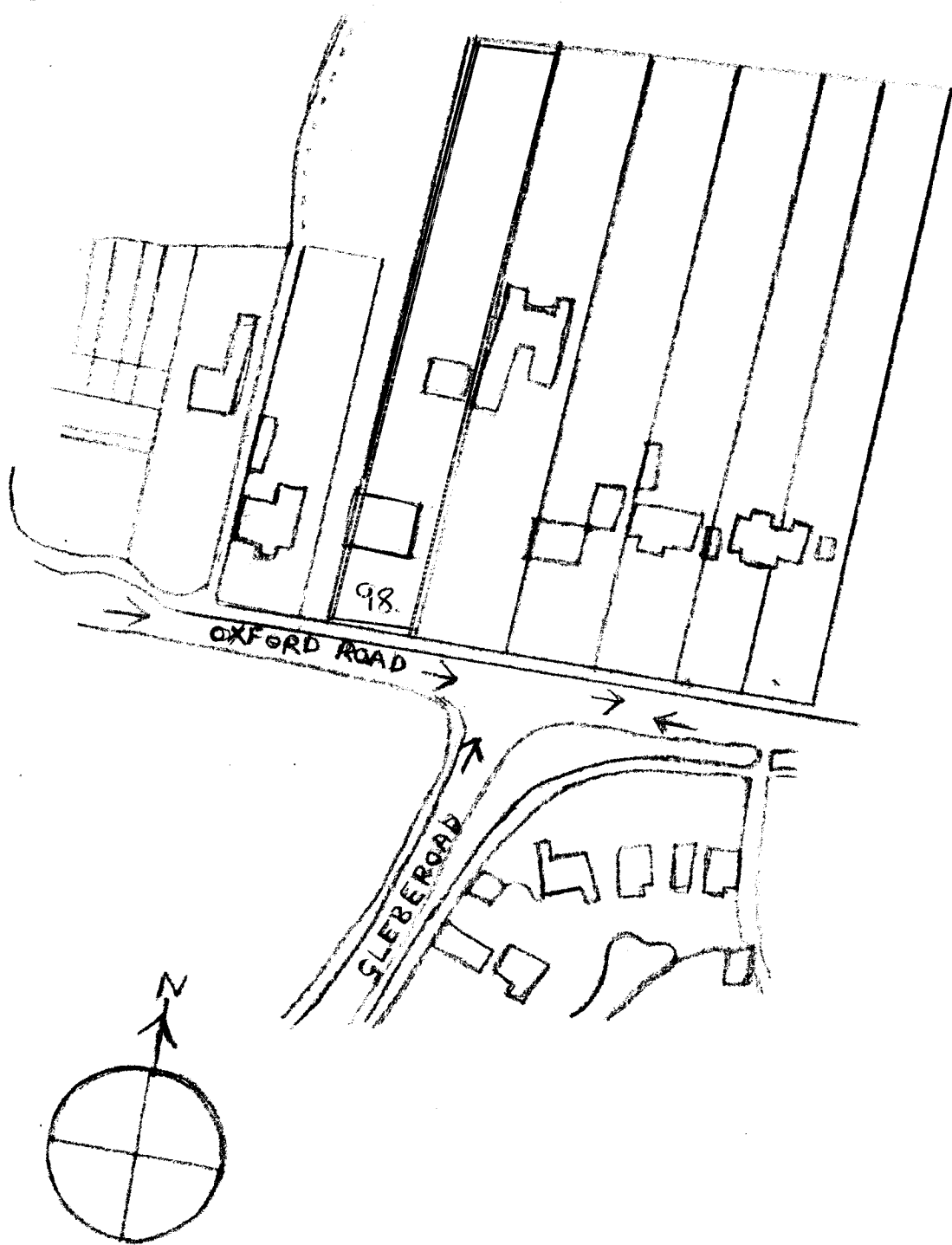

LOCATION PLAN

SCALE 1:1250

CUMNOR / AUGUST 2006

VALE OF WHITE HORSE
DISTRICT COUNCIL

REC'D 02 AUG 2006

CORPORATE POSTAL
SERVICES - 5

APPENDIX 2

CUM/59³²~~43~~/4-r

APPENDIX 2

SITE PLAN
1:500
98 OXFORD
ROAD

PROPOSED NEW DWELLINGS SITED TO MINIMISE IMPACT ON NEIGHBOURING PROPERTIES

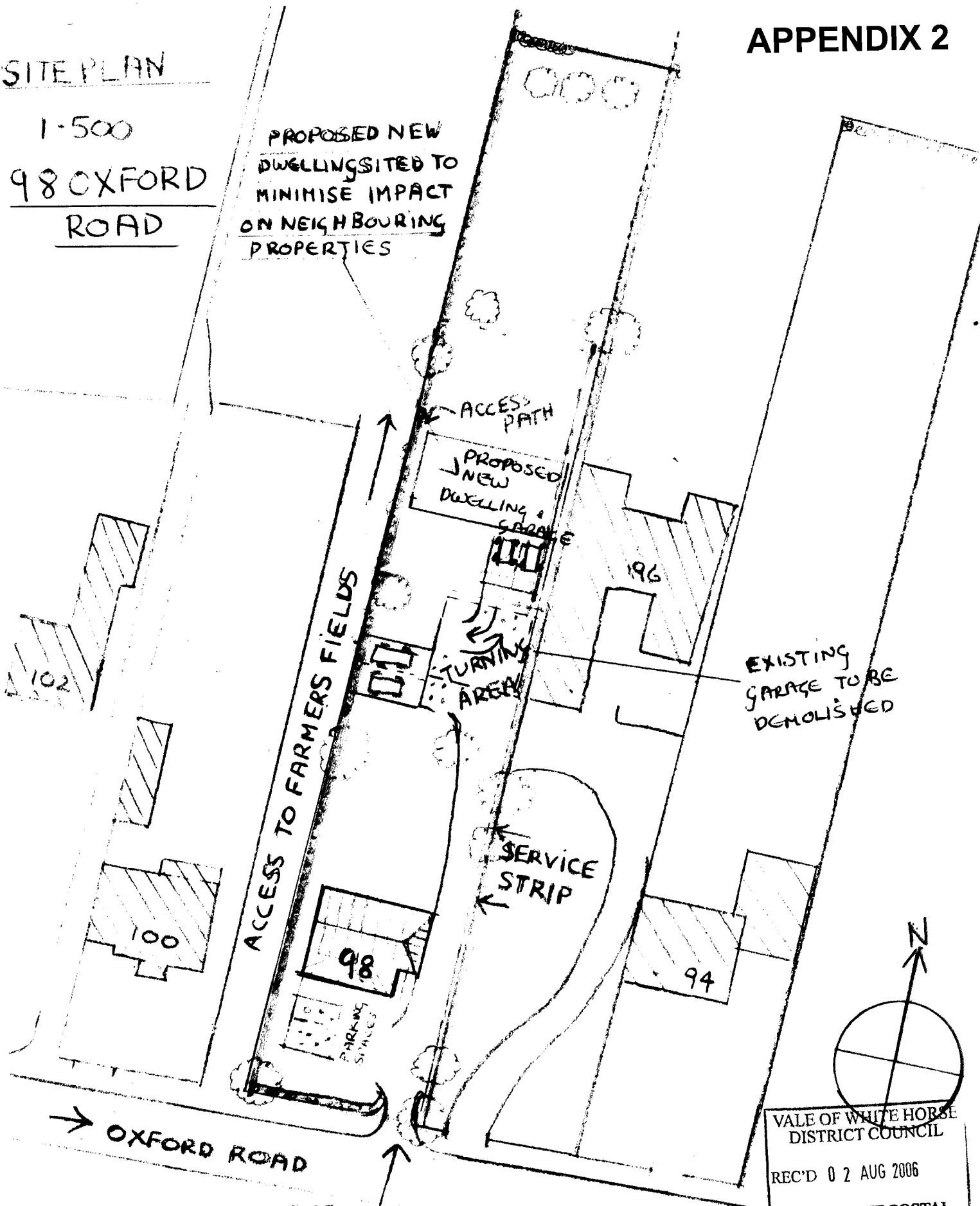

OXFORD ROAD

EXISTING ACCESS
RETAINED BUT WIDTH TO
SATISFY THE REQUIREMENTS
OF HIGHWAYS DEPT.

VALE OF WHITE HORSE
DISTRICT COUNCIL
REC'D 02 AUG 2006
CORPORATE POSTAL
SERVICES - 5

CUMNOR / AUGUST 2006

32
CM / 5943 / 4 - X